

CS-EXFL-04W

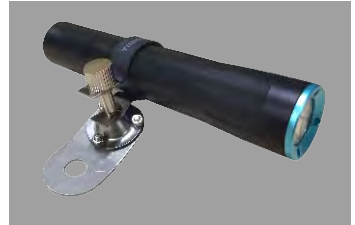

Technical parameters

Rated voltage: DC3.7V
 Rated capacity: 4,000mAh
 Rated power: 3W
 Average lifespan of light source: ≥100,000h
 Continuous discharge time: 8h (hard light), 16h (working light)
 Charging time: 6h
 Protection grade: Ip66
 Explosion-proof sign: Exd II CT6 Gb

Applicable place

- ◆ Applicable as movable lighting for Class IIC Group T1-T6, Zone 1, Zone 2, underground areas and other working sites of various flammable and explosive sites in relation to oil fields, smelting, railway, power, public security, petrochemical enterprises, etc.

Performance features

- ◆ Internationally leading brand of large-power LED solid-state light source, high efficiency and long lifespan, low consumption and energy conservation. The reflector is provided with high-tech surface treatment for highly efficient reflection, more than 200m irradiation distance and 5,000m visible distance.
- ◆ Lithium memoryless battery, featured with good charge & discharge performance, large capacity, low self-discharge, economic and environmental-protection performance; at least 4h continuous operation under hard light mode after one full charge, and at least 10h under working light mode, and provided with three working modes, i.e. hard light, working light, strobe light. The strobe light can instantly blinds any person within a range of 30m, so it provides vigilance and personal protection.
- ◆ The light-weight high-rigidity alloy housing can resist to fierce collision and impact, and specialized sealing structure design is waterproof and dustproof and can meet operation requirements under various harsh environments and climate conditions. Corner-angle lamp holder design can be used as a defense tool under emergent circumstances.
- ◆ Optimized circuit design provides battery over discharge protection, and the intelligent charger is provided with overcharge, short-circuit protection and charge display functions.
- ◆ Antiskid treatment on the outer surface, compact structure, light weight, easy operation, artistic appearance, and optional for hand-holding, waistband hanger suspension or pocket carrying.